



Gains Monitor System

Roberto Francisco Pérez Benito
on behalf of the HERMES collaboration

Roberto.F.Perez@mail.desy.de



II. Physikalisches Institut, JLU Gießen



Index

- Hermes
- Recoil Detector
- Scintillating fiber tracker
- Gain Monitor System



Hermes

- The missing mass resolution of the HERMES is not sufficient to identify exclusive events individually and to separate them

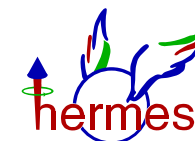
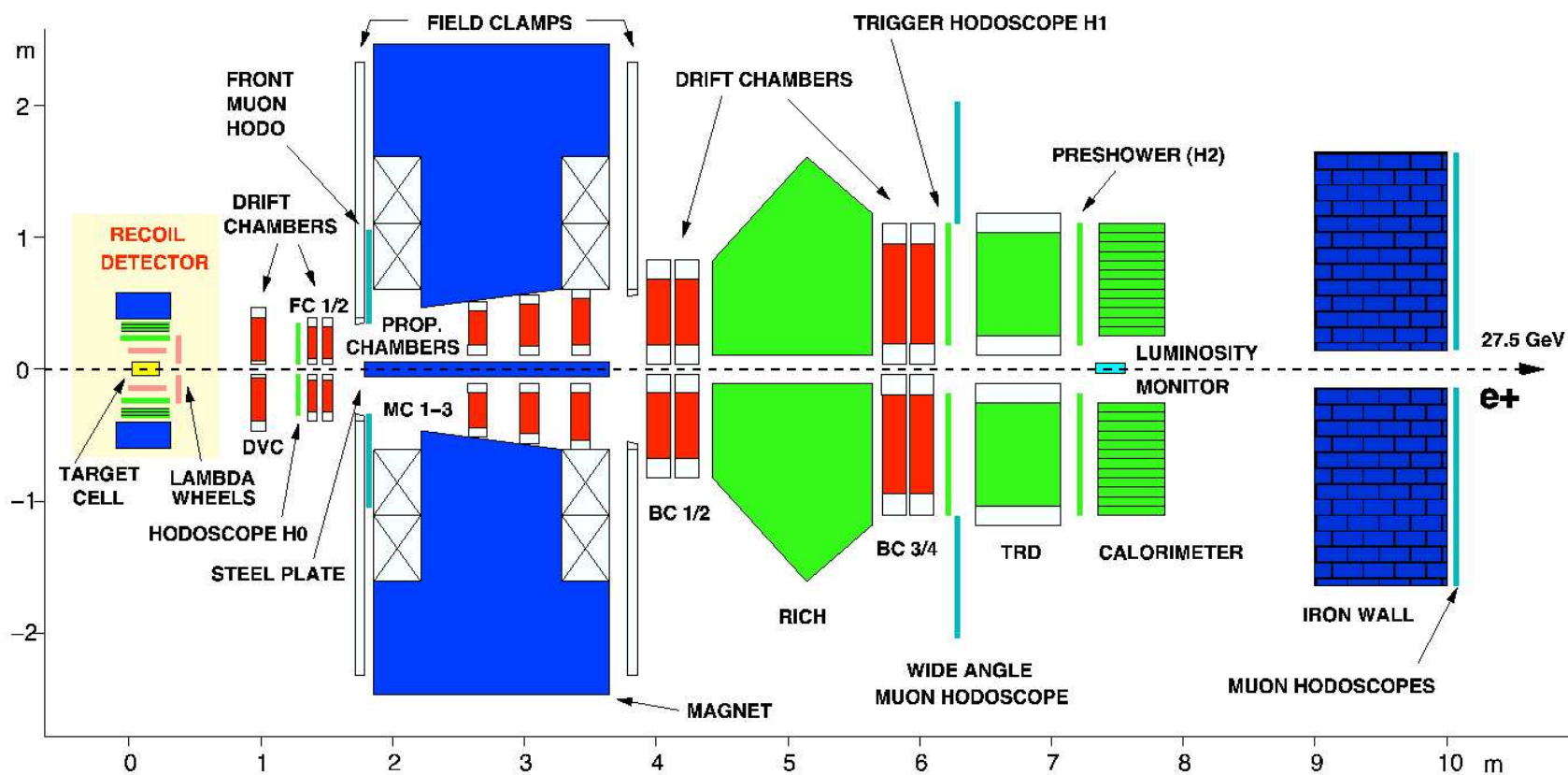

Recoil Detector

- The Hermes recoil detector will consist of three active detector components
 - Silicon detector surrounding the target cell, inside the beam vacuum
 - Scintillating fiber (SciFi) tracker in a longitudinal magnetic field of about 1 Tesla
 - Photo detector consisting of several scintillator layers
- the SciFi measures the momentum of recoil protons between about 250 and 1400 MeV/c



Recoil Detector

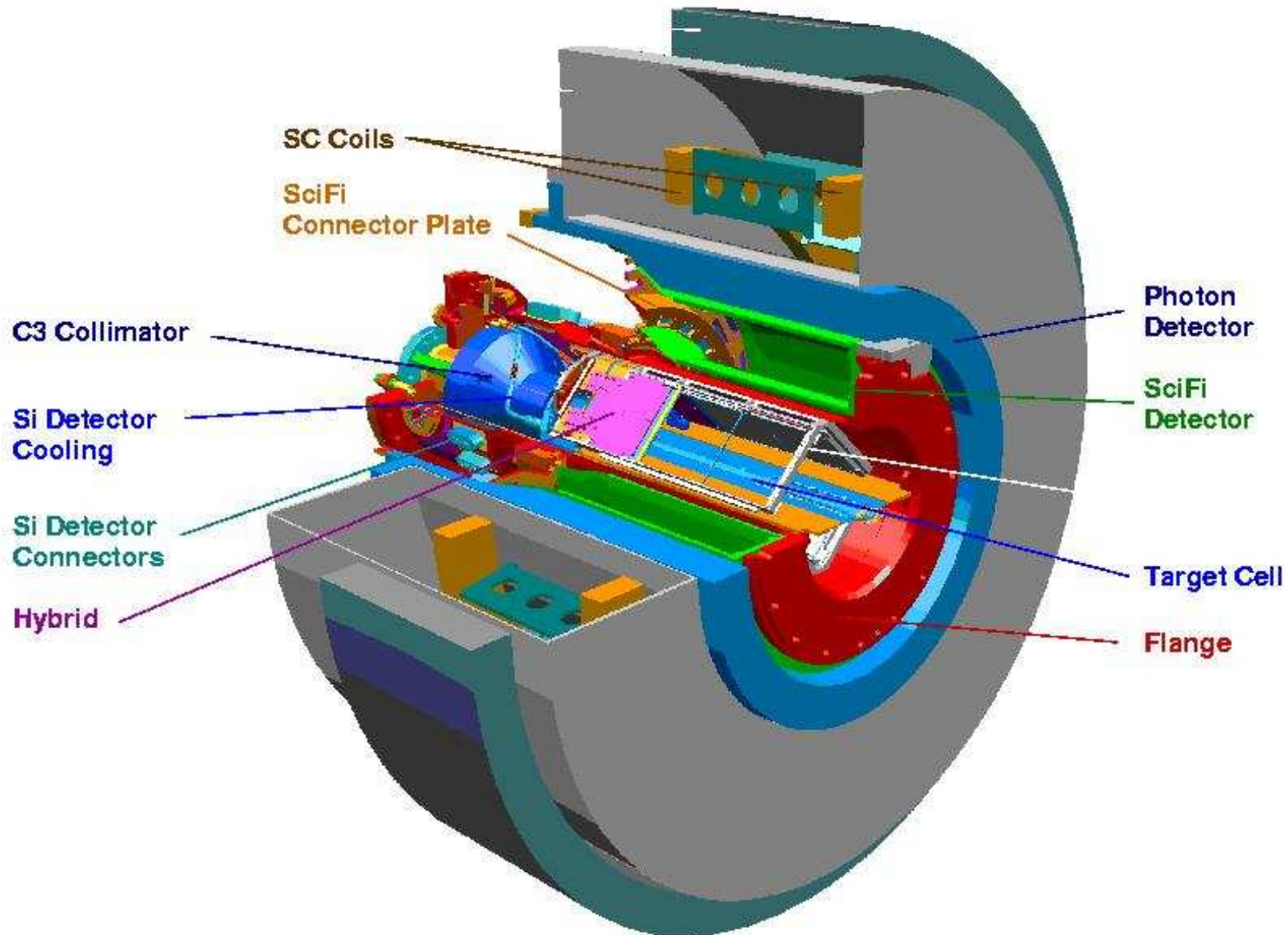

Scintillating fiber tracker

- Each SciFi cylinder contains two SciFi layer, one parallel and one stereo layer
- 21(18) modules are assembled to an inner (outer) SciFi layer
- SciFi Module consists of 64 (128) fibers for inner (outer) cylinder arranged in two layer
- Kuraray SCSF-78 M fibers read out by 64 chn. Hamamatsu PMTs and high density customized VME electronics



Scintillating fiber tracker

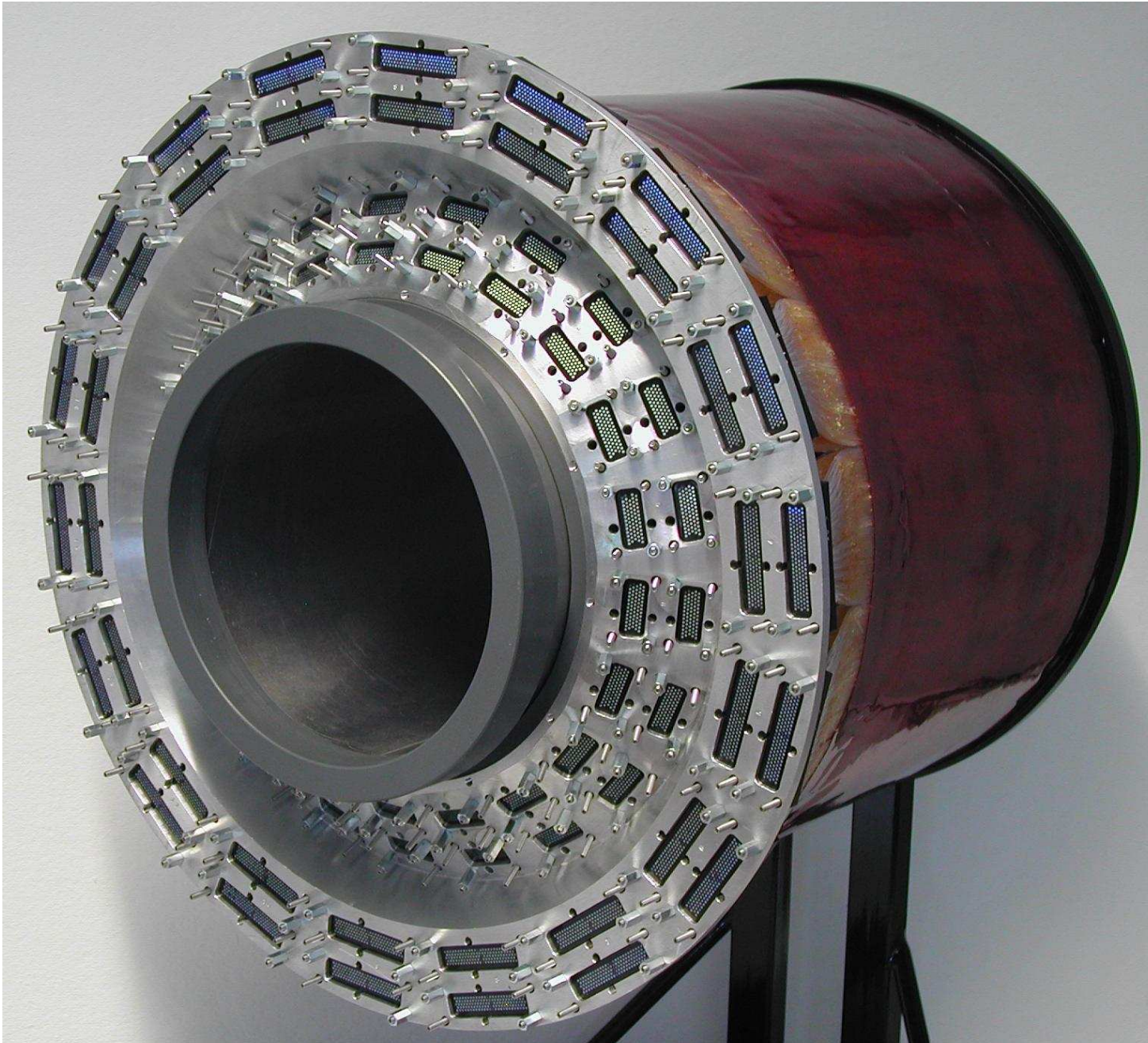

Scintillating fiber in Module

Outer layers



dgDET
 } 244 stereo
 } 242 parallel
 outer stereo
 outer stereo
 glue 0.1 mm
 outer parallel
 outer parallel
 glue 0.1 mm
 kapton 0.125 mm

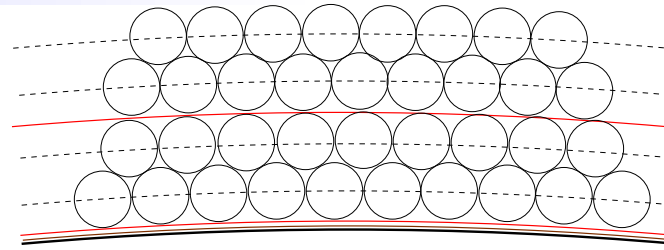

← $R_8 = 186.625 \text{ mm}$
 ← $R_7 = 185.725 \text{ mm}$
 ← $R_6 = 184.625 \text{ mm}$
 ← $R_5 = 183.725 \text{ mm}$
 ← $R_{\text{outer}} = 183 \text{ mm}$

Inner layers

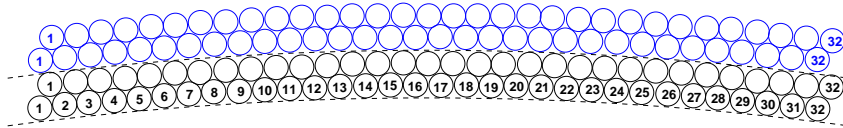

dgDET
 } 241 stereo
 } 240 } stereo
 } 239 } parallel
 } 238 }
 inner stereo
 inner stereo
 glue 0.1 mm
 inner parallel
 inner parallel
 glue 0.1 mm
 kapton 0.125 mm

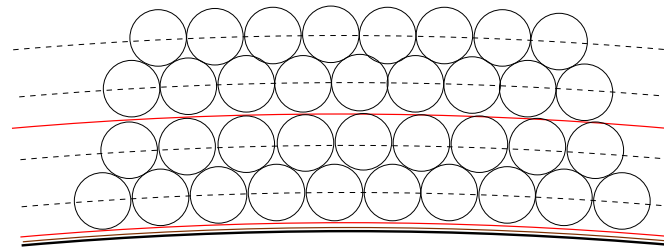

← $R_4 = 112.625 \text{ mm}$
 ← $R_3 = 111.725 \text{ mm}$
 ← $R_2 = 110.625 \text{ mm}$
 ← $R_1 = 109.725 \text{ mm}$
 ← $R_{\text{inner}} = 109 \text{ mm}$

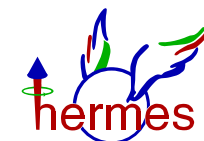
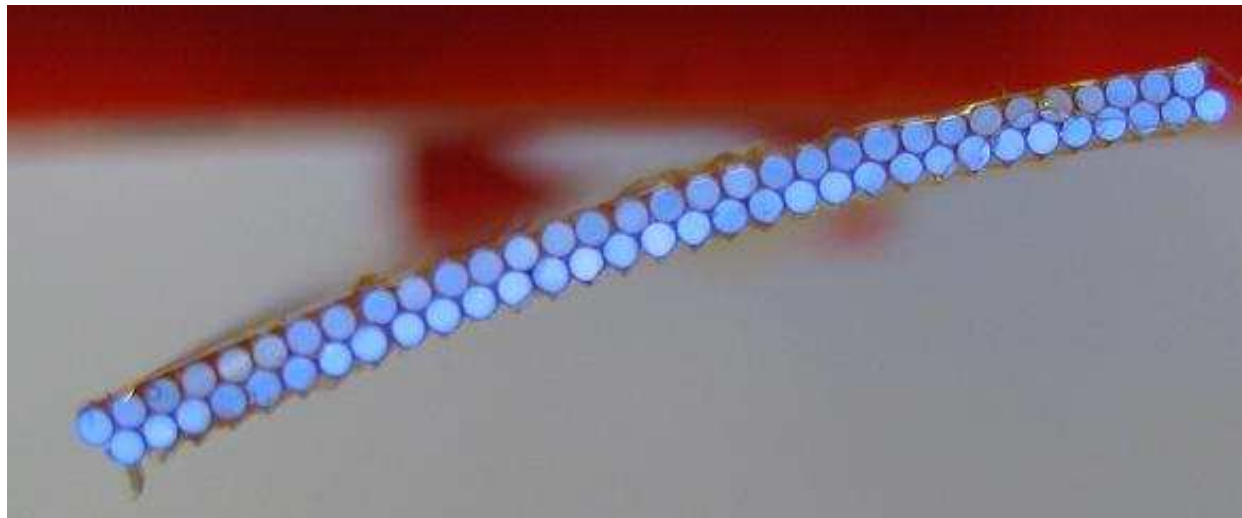

GMS in SFT

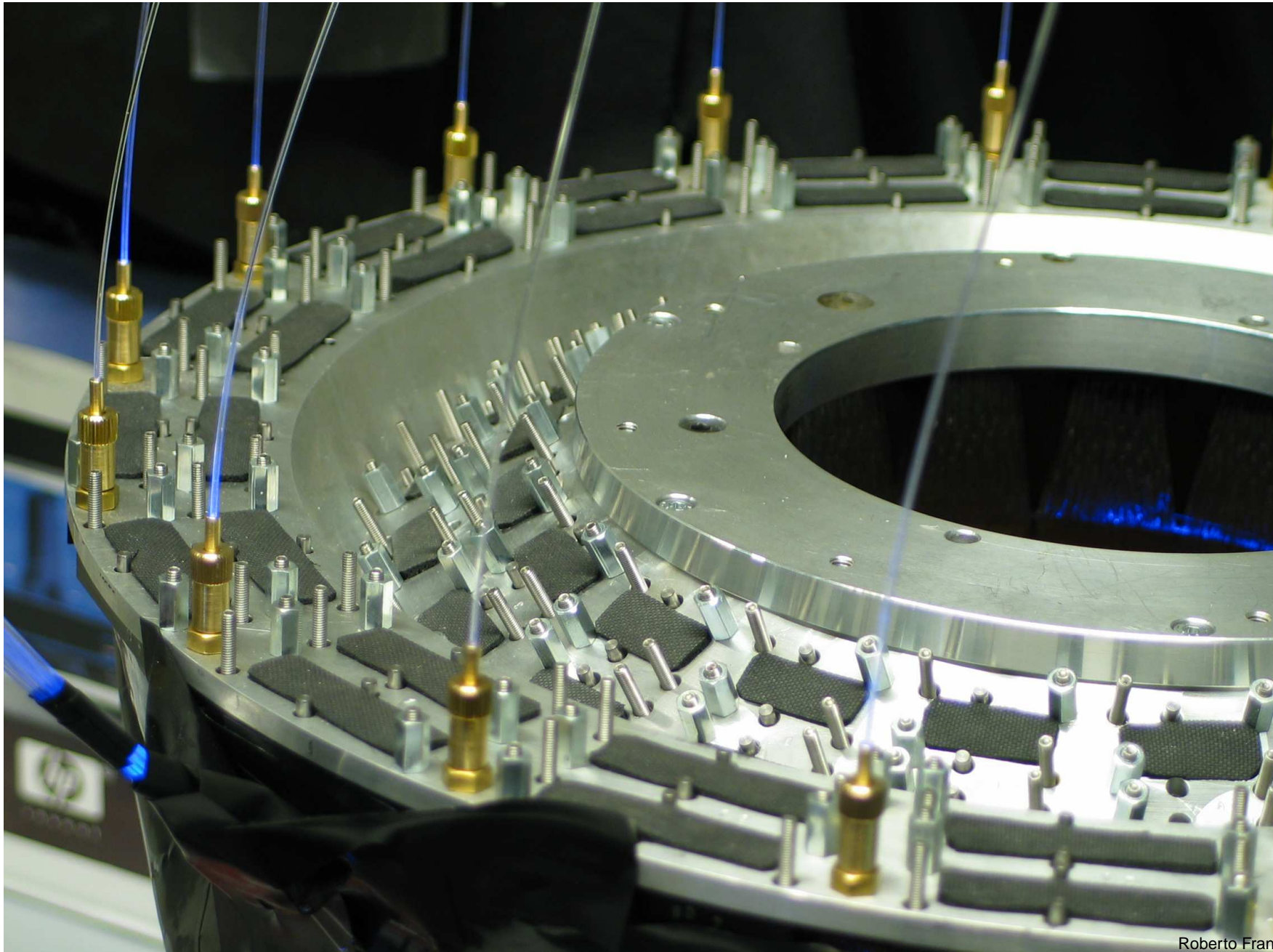

GMS instalation

G.M.S. Position SFT IN & OUT

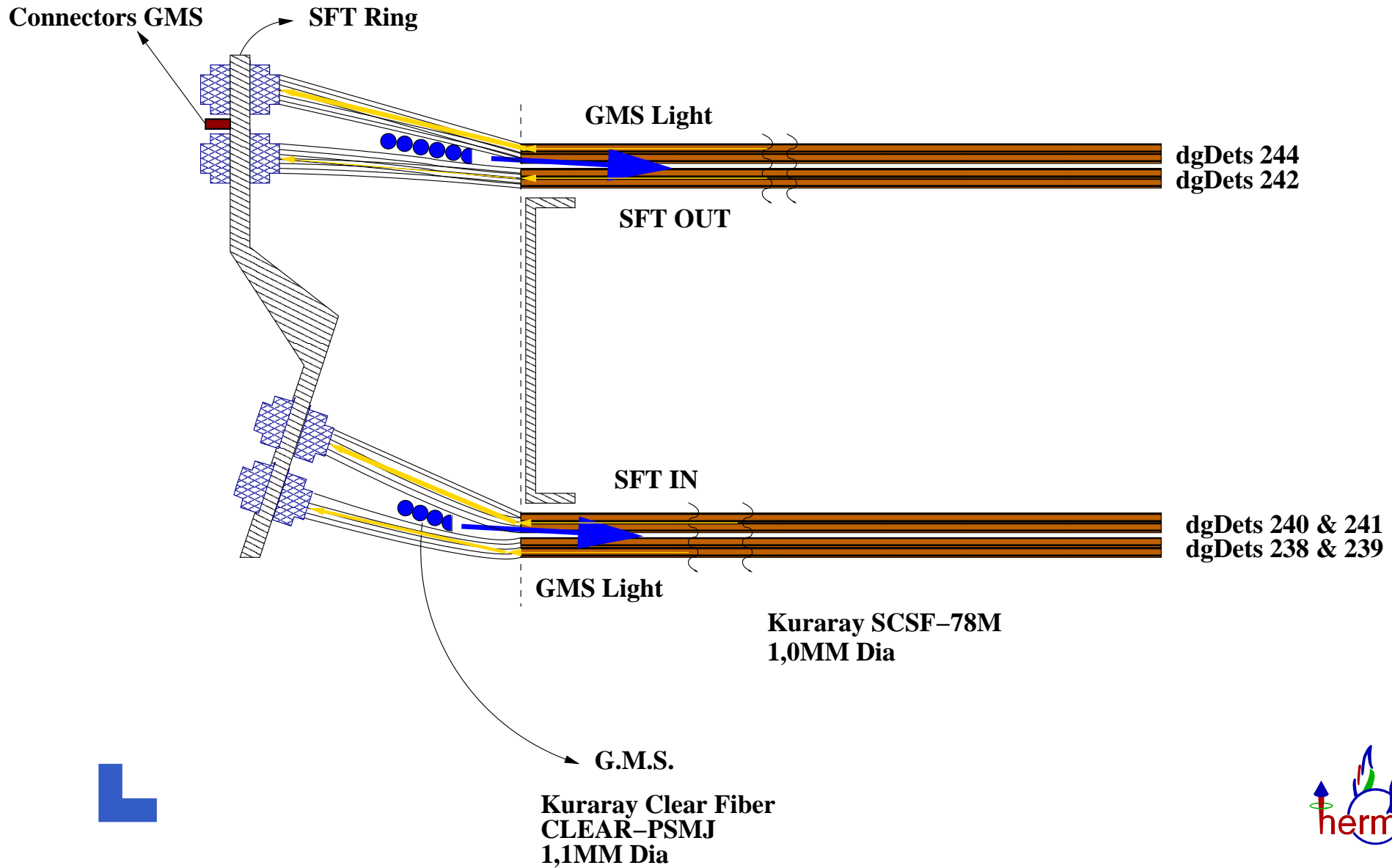

GMS - Connectors

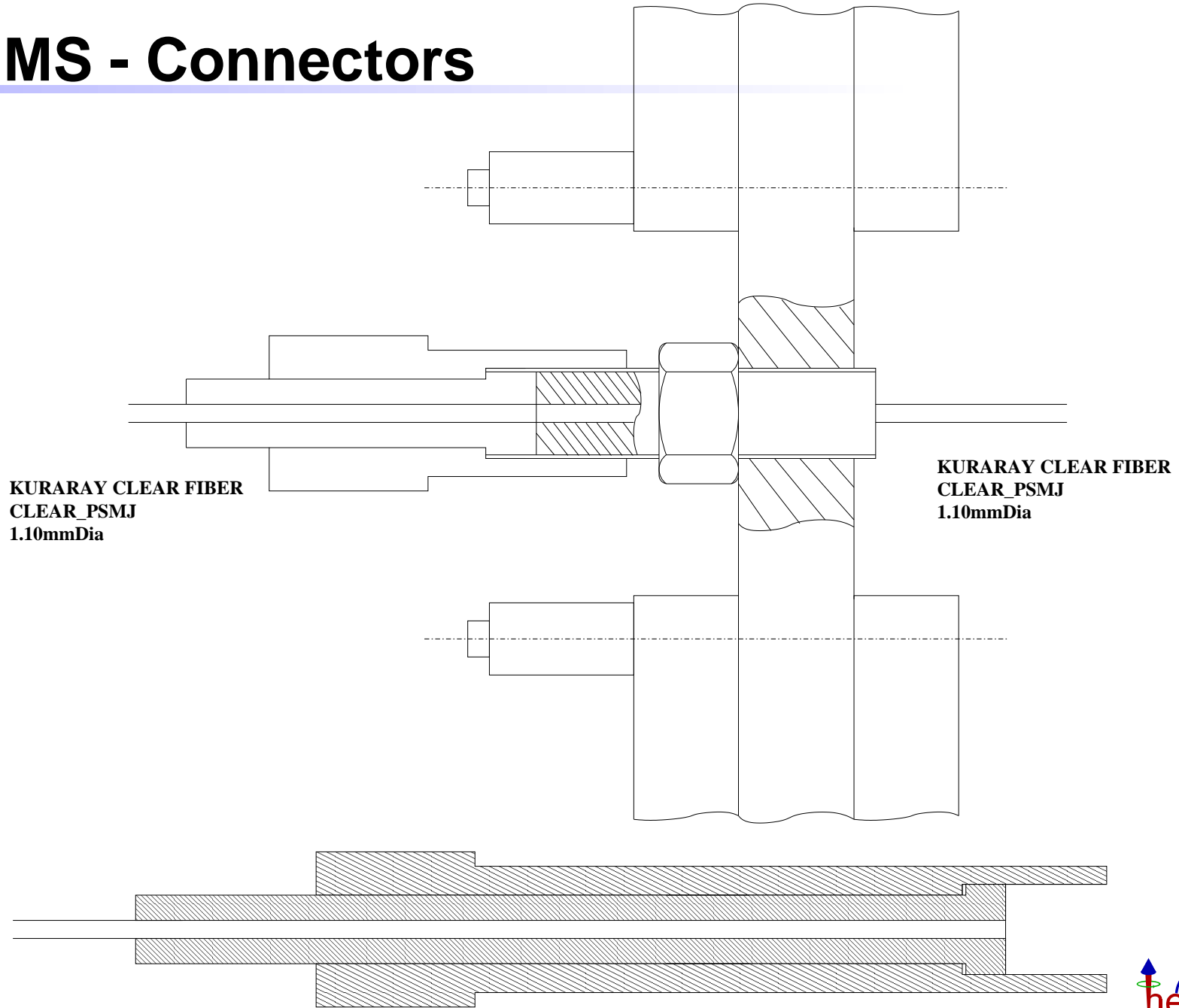

GMS Light source



HERMES – LED Focus Box

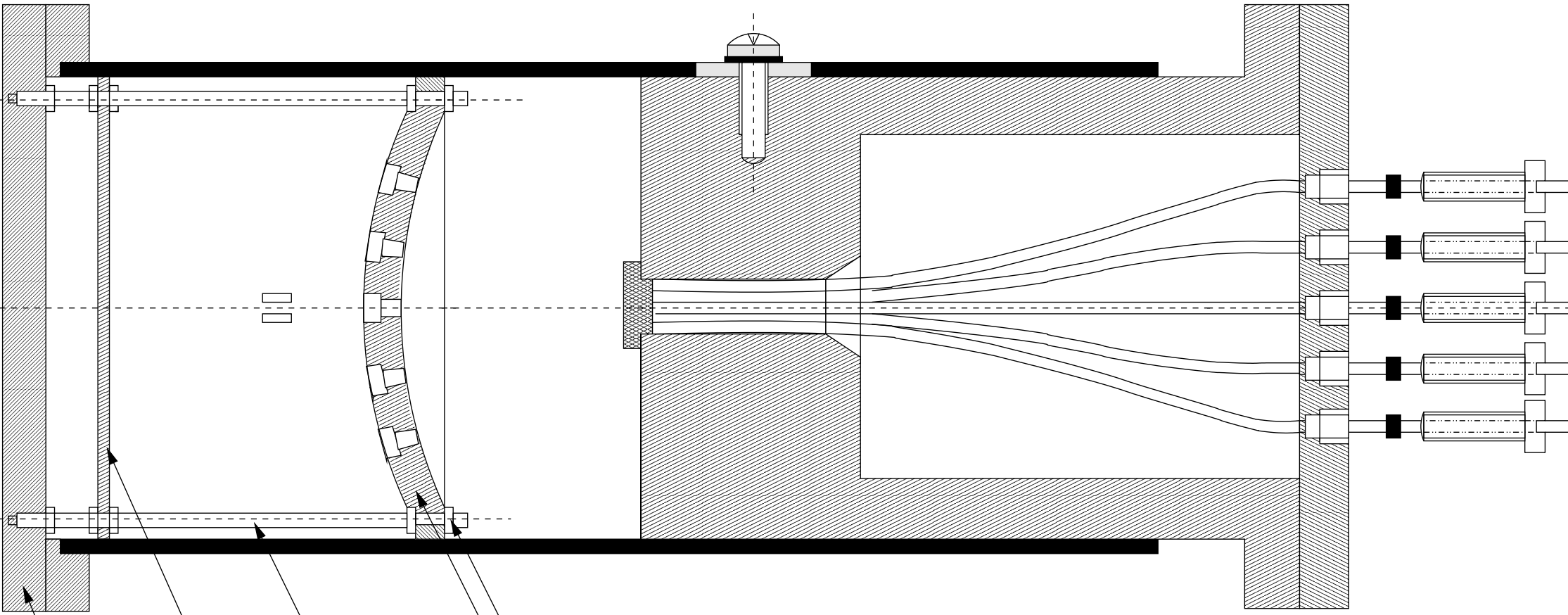

1 2 3 5 4



GMS Scheme

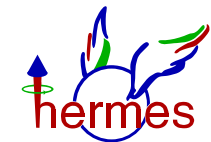
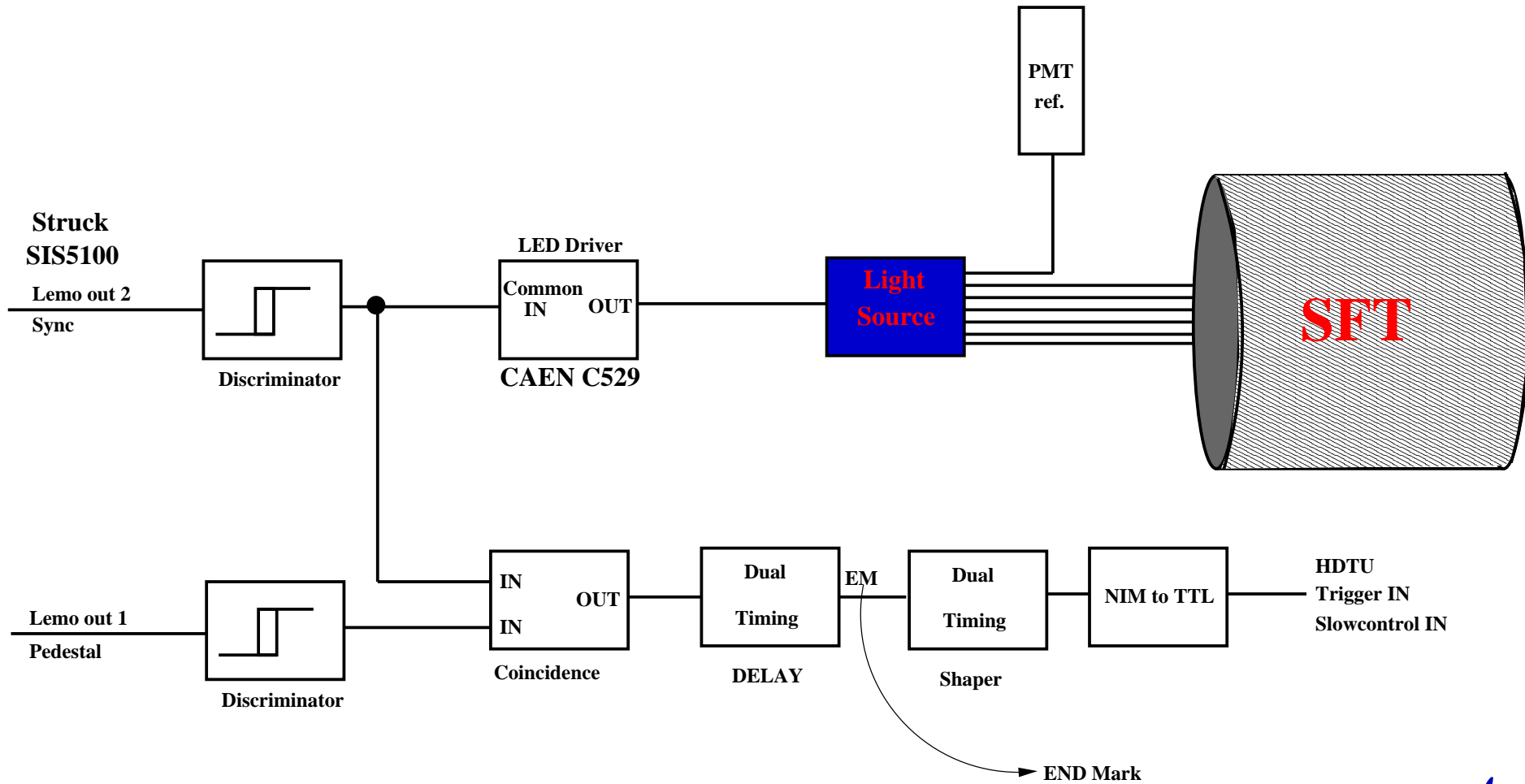

Alpha Source for GMS

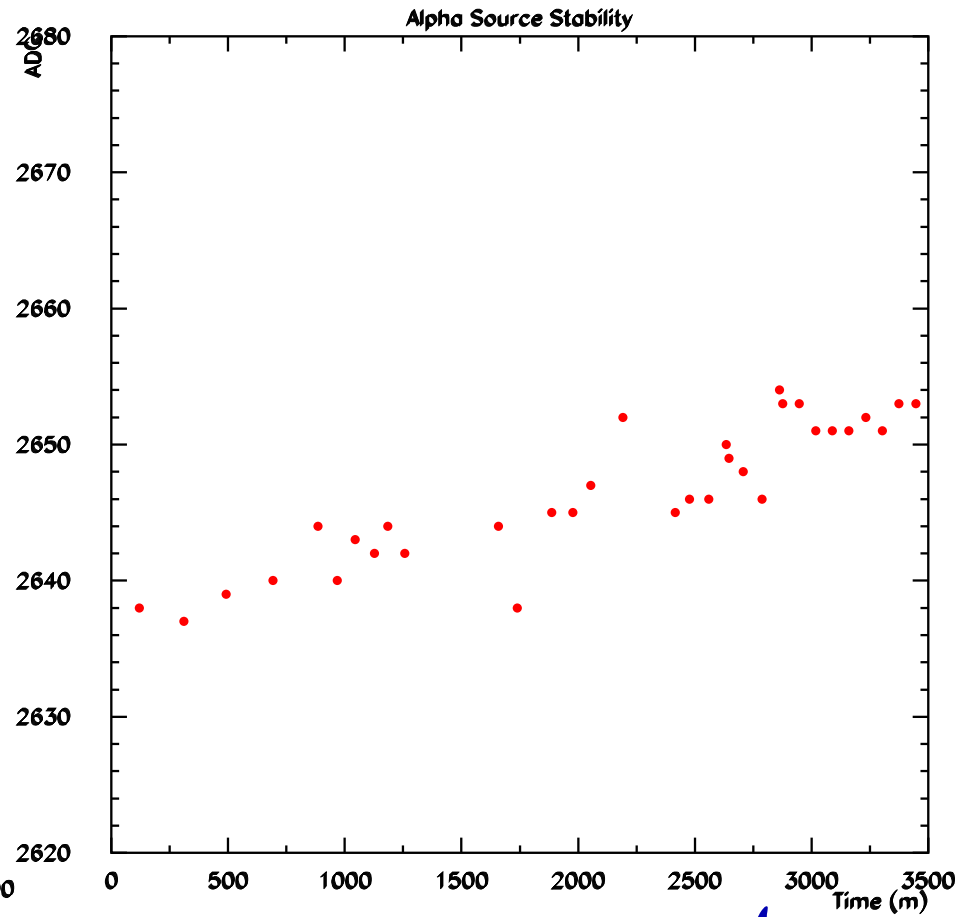
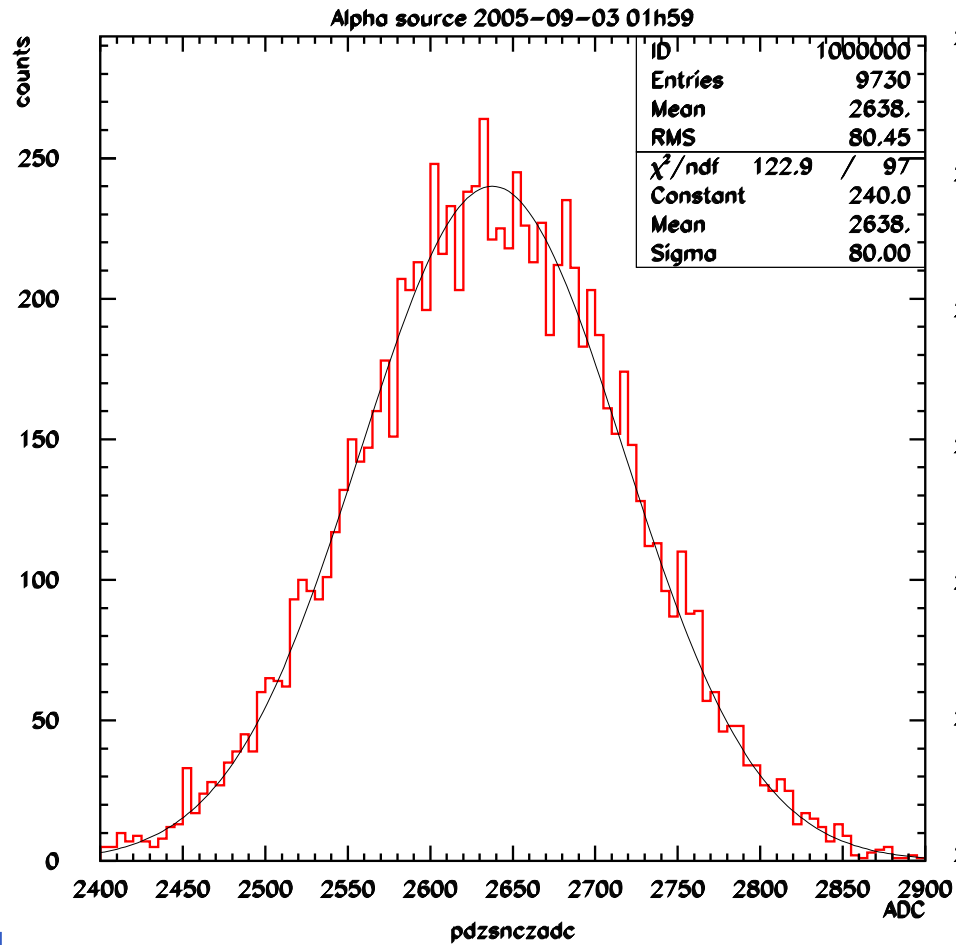

one run



PMT ref. for SFT GMS

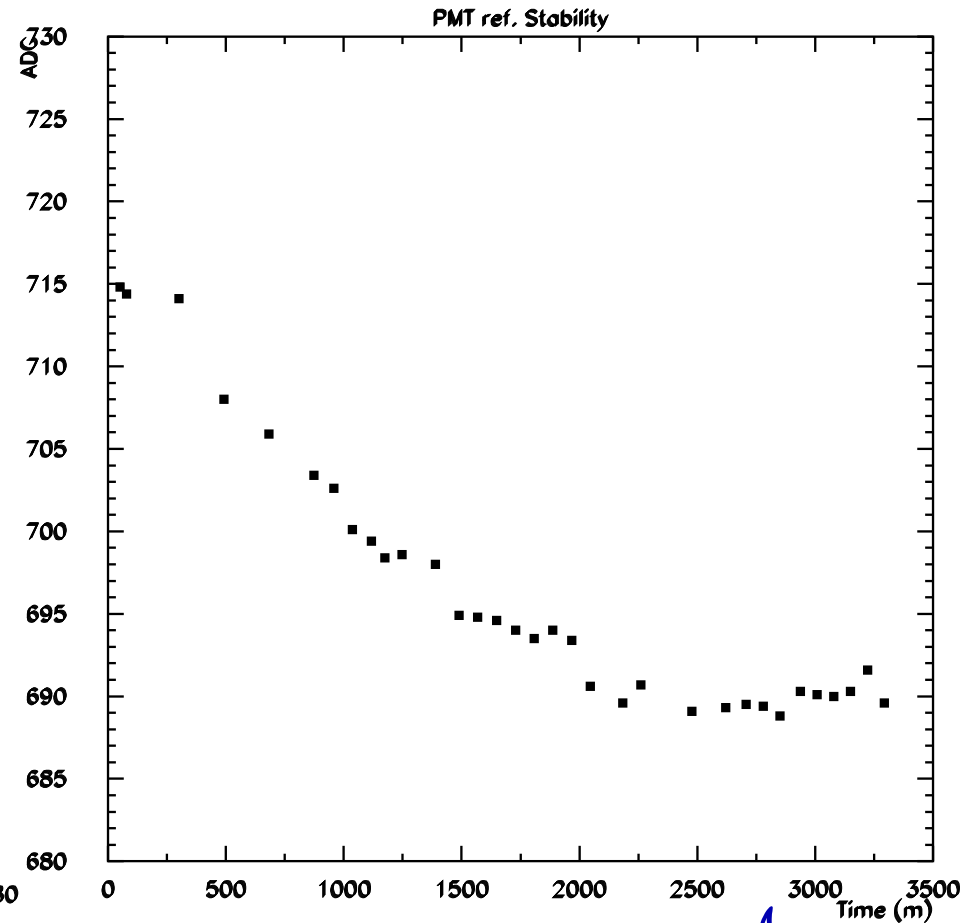
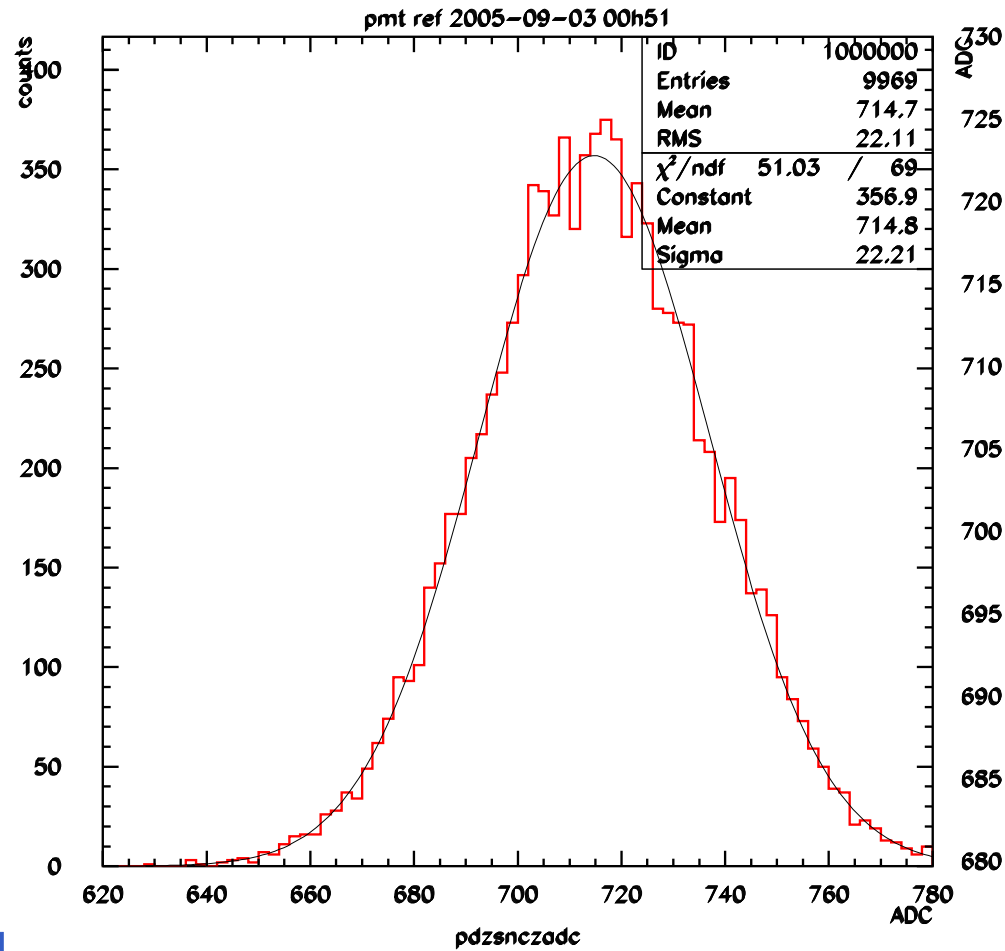

one run

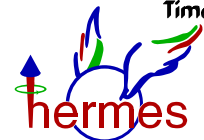

Gain Stability SFT

fit in one Gauss and two Poisson corresponding to the pedestal and the first and second p.e.

